

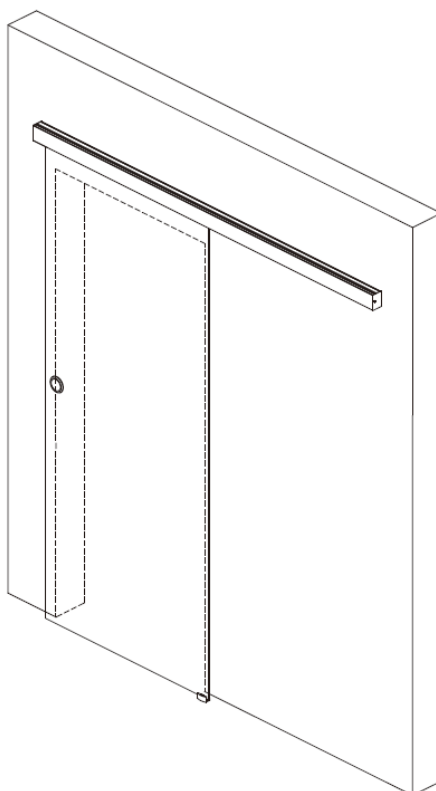

IMPORTANT SAFETY NOTES

- Under no circumstances should you attempt to drill through the glass, damage or injury may occur
- Please handle all glass with care, avoiding knocks and shock loading to all sides and edges. Safety glass cannot be reworked.
- Care should be taken when drilling into walls to avoid hidden pipes or electrical cables.



Scan this QR code for installation video.

Sliding Door Without Soft Close Instructions

Tools Required

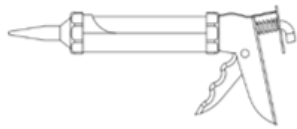

Silicone Gun

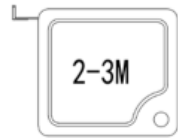

Tape Measure



Scissors

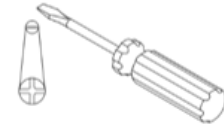

Philips Screwdriver



Hammer



Allen Keys

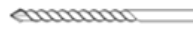

Drill Bit



Pencil



Power Drill



Level

Two people required. We recommend that a technically competent installer should undertake this installation.

Be sure you have all included parts and tools required before beginning installation and that you have plenty of space for assembly.

PRE-INSTALLATION AND TECHNICAL REQUIREMENTS

- All dimensions are shown in millimetres, except where otherwise indicated.
- Ensure that the enclosure set is fitted to a level floor and vertical wall surface.
- This instruction manual is applicable for both pre-tiled wall and plain walls.
- The wall fixings included with this product are suitable for solid walls only. Plasterboard or stud walls may require specialist fixings (not supplied).
- Due to the possibility of residual spray, the area around the outside of the shower tray should be tiled, or made otherwise water resistant.

IMPORTANT SAFETY NOTES

- Under no circumstances should you attempt to drill through the glass, damage or injury may occur
- Please handle all glass with care, avoiding knocks and shock loading to all sides and edges. Safety glass cannot be reworked.
- Care should be taken when drilling into walls to avoid hidden pipes or electrical cables.

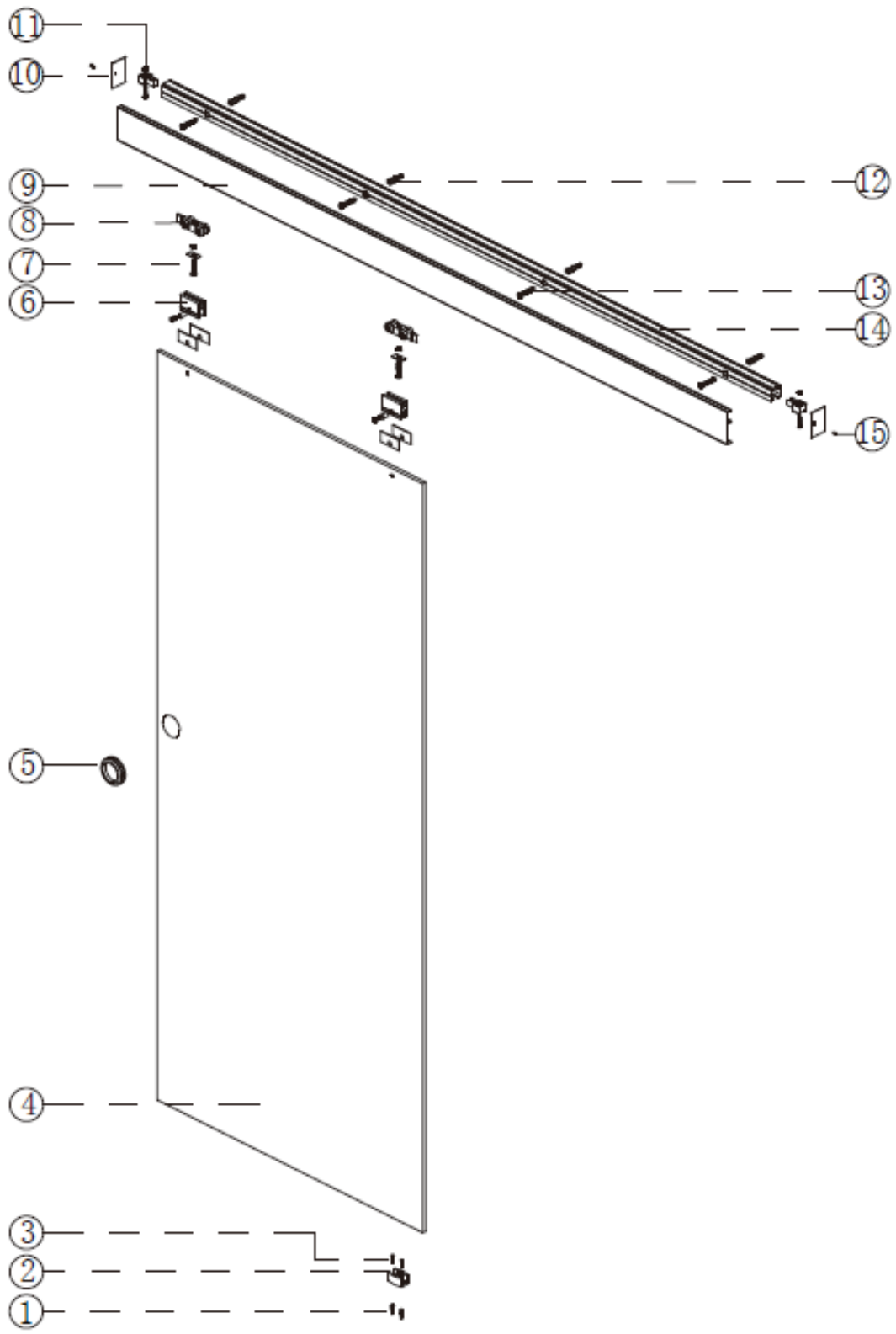

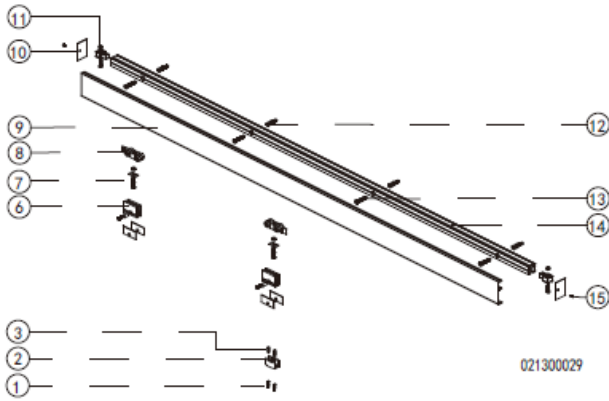

Montage Amalfi 1550-2050 Alu
Laufschienen
(LG)

<p>01 030150006 X2</p>	<p>02 021300032 X1</p>	<p>03 020900029 X2</p>
<p>06 100700169 X2</p>	<p>07 020600010 X2</p>	<p>08 020600010 X2</p>
<p>09 X1</p>	<p>10 021300033 X1/RX1</p>	<p>11 020600010 X2</p>
<p>12 030500021 X4</p>	<p>13 020900035 X4</p>	<p>14 X1</p>
<p>15 020900027 X2</p>		

